

## PE12V4.5F1



### Specifications

Nominal Voltage	12 V
Rated Capacity (20 hour rate)	4.5 Ah
Weight	3.86 lbs. (1.75 kg)
Case Material	Synthetic Resin (ABS)

### Dimensions

Length	3.54 inch (90.0mm)
Width	2.76 inch (70.0mm)
Height	4.02 inch (102.0mm)
Total Height	4.17 inch (106.0mm)

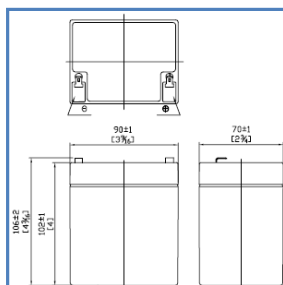

**Standard Terminal**  
F1 : AMP Fasten  
Type 187

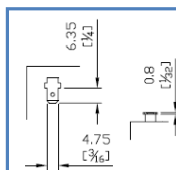

### Characteristics

Energy Density	1.38 Watt-hours/cubic inch
Specific Energy	14.0 Watt-hours/pound
Maximum Discharge Current with Standard Terminals	27 A
Maximum Short Duration Discharge Current	67.5 A (less than 5 sec.)
Vibration Test	No Loss Capacity or Performance (2000 cycles/minute, 0.10 excursion, 2 hours)
Charge Retention (Shelf Life)	% of Nominal Capacity at 77°F (25°C) 1 month 97% 3 month 90% 6 month 80%
Recommended Ambient Temperature Range	Charge : 32°F (0°C) to 104°F (40°C) Discharge : -4°F (-20°C) to 122°F (50°C) Storage : -4°F (-20°C) to 104°F (40°C)
Internal Resistance of Fully Charged Battery	70 milliohms

### Charging

Recommended Charging Methods	<b>CYCLE USE :</b> Maximum Initial Charge Current : 1.125A Charging Voltage : 14.4 ~14.7V Charge Should Be Switched to Float Mode or Disconnected When Current Drops to 45mA
	<b>STANDBY USE (Float) :</b> Maximum Initial Charge Current : 1.125A Charge Voltage : 13.5 ~13.8V

End of Discharge Voltage		Discharge Time										
		10M	15M	30M	1H	2H	3H	4H	5H	8H	10H	20H
10.8V	W	108.73	81.41	47.31	28.23	16.66	12.08	9.73	8.14	5.51	4.61	2.54
	A	8.95	6.76	3.88	2.31	1.37	0.99	0.80	0.67	0.45	0.38	0.22
10.5V	W	113.77	85.37	48.84	29.19	17.23	12.47	10.05	8.39	5.70	4.76	2.63
	A	9.42	7.09	3.99	2.37	1.42	1.02	0.83	0.69	0.47	0.39	0.23
10.2V	W	119.33	89.23	50.36	30.08	17.74	12.84	10.37	8.65	5.88	4.91	2.72
	A	9.84	7.38	4.11	2.44	1.46	1.05	0.85	0.71	0.48	0.40	0.23
9.6V	W	128.65	95.15	53.48	31.98	18.82	13.67	11.00	9.16	6.24	5.21	2.88
	A	10.61	7.85	4.38	2.62	1.56	1.12	0.90	0.75	0.51	0.43	0.25